

Saint John's

college school

The New Senior House



Acknowledgements

Architect
Cavaleri Partnership

Quantity Surveyor
Tillyard

Building Contractor
TJ Evers Ltd



The New Senior House

opened on 13th June 2013 by Professor Christopher M Dobson FRS
Master of St John's College

The Senior House site, home to boys and girls aged 9 - 13 (approximately 230 pupils in all) has been completely redeveloped. In addition to existing facilities such as the Chapel, Theatre, Gymnasium, Science Laboratory, Art Room, ICT Room, Swimming Pool and Music School, the site now boasts 14 new classrooms, an outstanding Library, a new DT and Computer Control and Graphics facility, a second Science Laboratory, a new Drama Studio, new Music facilities, a Quiet Garden, a new Multi-Sports Court and changing block, extensive new storage and excellent staff facilities. A short walk away is the new Boarding House which accommodates up to 40 boys and girls.



A Map of the Site

- 1-9 Ground Floor Classrooms
10-15 First Floor Classrooms

- A Main Entrance & Visitor Parking
B Library, First Floor
C Piazza
D Music School
E Quiet Garden
F Music, Ground Floor & Science, First Floor
G ICT, Ground Floor & Science, First Floor
H Drama Studio
J Swimming Pool & Changing Block
K Multi-Sports Court
L Computer Control & Graphics
M Design Technology
N Garden
O Art
P North Drive





The Piazza

At the heart of the Senior House site, the Piazza has been expanded and redesigned to bring together the main buildings into a unified space, offering a full view of the main facilities. It is complemented by a covered walkway which links three sides.

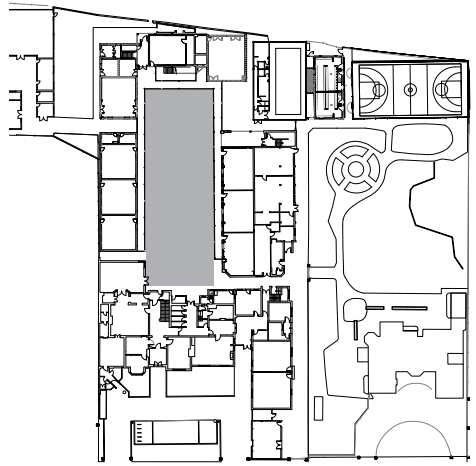



The Piazza Classrooms

Six large new classrooms have been created in the Piazza, three on the right underneath the existing first floor Hinsley Hall, and three on the left with pitched roofs and sky lights. All classrooms have been designed with careful thought for light and ventilation and an ample supply of storage.

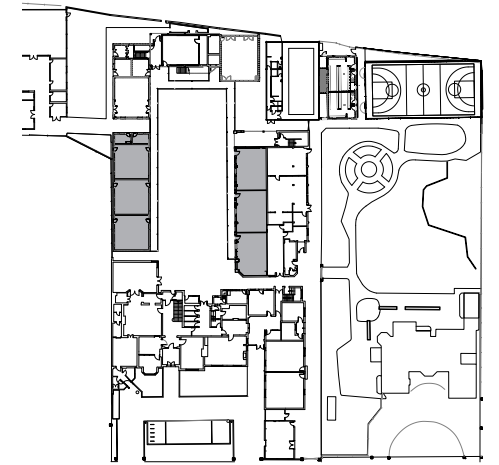



Classrooms in the Main Building

A further eight new classrooms have been created by converting existing spaces within the main building, vacated by the move of the Boarding House to 69 Grange Road. The new classrooms have splendid views over Grange Road to the playing fields and over the expanded and repaved North Drive to the garden. All classrooms are fitted with interactive white boards.

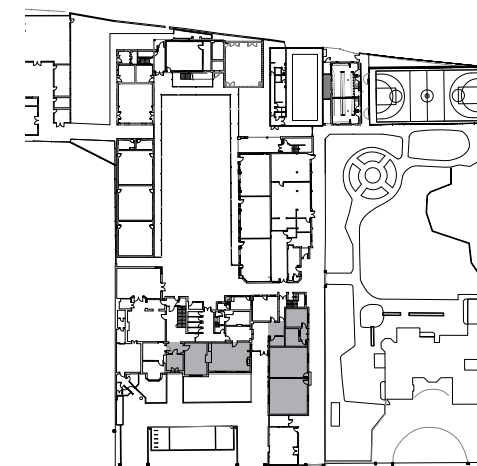

The Library

The large new Library is an outstanding resource with an excellent range of both fiction and non-fiction housed in bespoke solid wood shelving. Cushions and window seats provide a comfortable environment for the children to lose themselves in a book and a large communal table is the perfect setting for studying or research using netbooks.

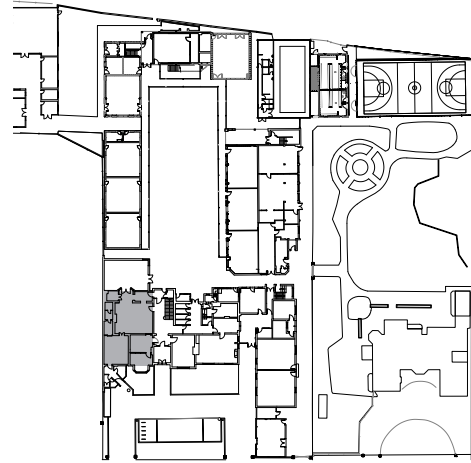



The New Science Laboratory

A spacious and well-equipped second Science laboratory occupies the first floor above the new Music facilities. Floor to ceiling windows fill the room with natural light and there is generous space for the children to conduct experiments. At the front is a demonstration area, with an interactive white board and a smoke cupboard.

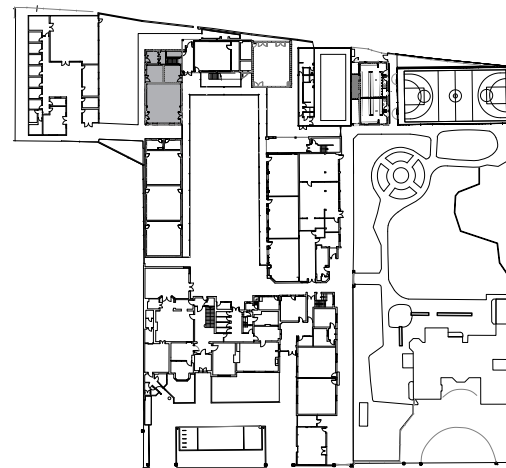



The Drama Studio

A wonderful addition for the whole school community to use, the Drama Studio is a visual focal point at the end of the Piazza. It offers excellent rehearsal space, which can be doubled by opening its concertina glass doors fully to blend seamlessly with the adjoining outdoor space. When not in use for Drama, with a full range of audiovisual equipment, the Studio is the perfect setting to accommodate presentations from visiting speakers and other year group activities.

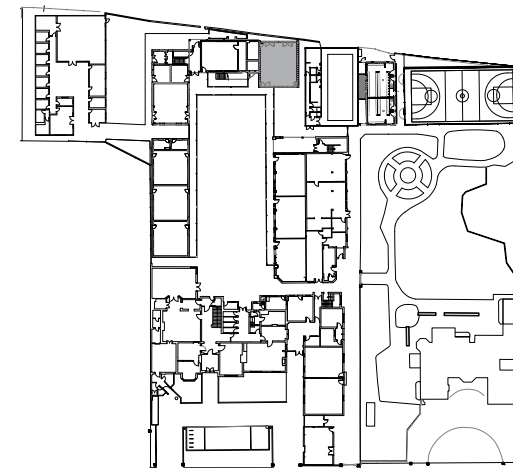

New Music Facilities and the Quiet Garden

A new sound-proofed Music Room has been built, large enough to hold class music lessons and some of the many instrumental groups which meet throughout the week. Three light and airy, sound-proofed music practice rooms have also been added.

The new Music facilities give onto the beautiful new Quiet Garden, a calm outdoor space designed with peace in mind, which provides an area for the children to read or chat with their friends. Plants and trees line the new pond with its waterfall feature.

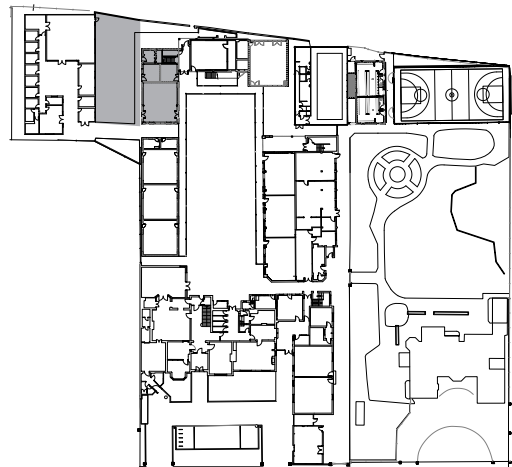



Design Technology Room & Computer Control and Graphics Room

The beautifully redesigned Design and Technology Room contains state of the art resources, including a separate power-tools area, that allow an extensive range of advanced projects to be undertaken. The adjacent Computer Control and Graphics Room, equipped with a suite of new computers enables computer-aided design to be at the forefront of many Design Technology lessons.

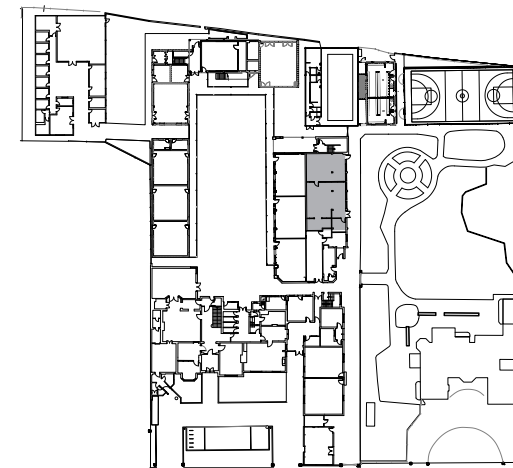



The Multi-Sports Court & Changing Block

A Multi-Sports Court, boasting a wonderful view of the garden of Garden House, is a superb resource for the teaching of PE and Sports and is much in demand at break times. The adjacent and spacious changing block, which backs onto the existing swimming pool, provides ample areas for both boys and girls and links directly to the court.

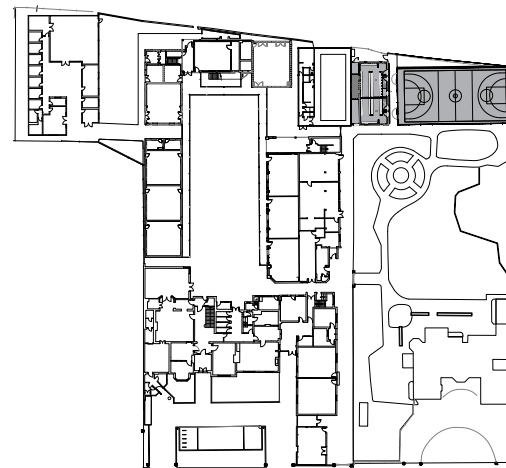

Other Facilities

The Senior House reception area has been completely redesigned to allow more space to welcome visitors into a new waiting room and facilitate a free flow through the main entrance hall.

Staff facilities have been significantly improved with two new large work rooms offering generous storage. Lockers have been fitted for both staff and children to store belongings neatly, and a pupil sports kit store now stands at the entrance to the North Drive.

The children also now benefit from a dedicated indoor relaxation space with comfortable seating for use in cold or wet weather.

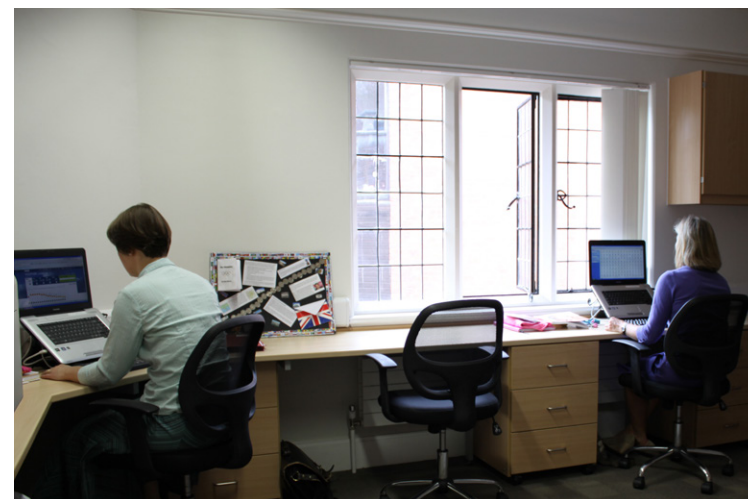
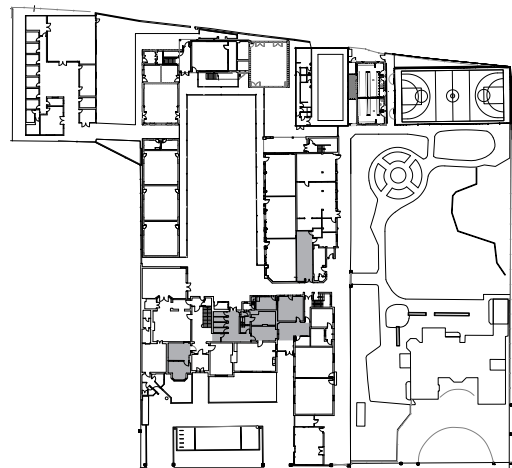



The Boarding House

The buildings programme began with the creation of the stunning new Boarding House, Whitfield House, which opened its doors to boarders at the start of the Summer Term 2011, allowing the space they had previously occupied at Senior House to be completely redesigned.

Home to up to 40 boys and girls, Whitfield House sits within its own grounds a few short paces from Senior House. This spacious accommodation includes a Recreation room with pool and football tables, beanbags to relax on and a games and television area. The library offers a peaceful area to read or study and the large family kitchen, with its central wooden table, looks out onto the garden with raised vegetable beds, table tennis table and a grassy play area.





© St John's College School 2013